

L-3322B

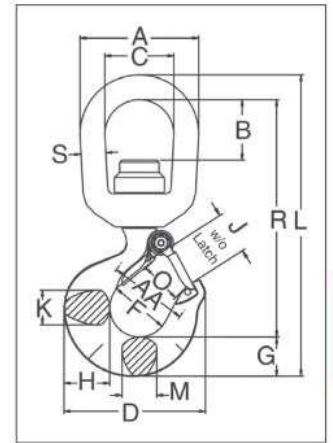

- Bearing design allows hook to rotate freely under load.
- Capacities ranging from 2 through 15 metric tons.
- Forged, Quenched & Tempered.
- Low profile hook tip designed to utilize Crosby S-4320 or PL-N latch kit.
- L-3322 hooks incorporate QUIC-CHECK® deformation and angle indicators. (For detailed information, see the Crosby Value Added page at the beginning of this section.)



4



APPLICATION AND WARNING INFORMATION
SECTION 17

L-3322B Swivel Hooks with Bearing

Working Load Limit (t)	Hook ID Code*	Stock No.	Weight Each (lb)	Dimensions (in)														Rep. Latch Stock No.	
				A	B	C	D	F	G	H	J	K	L	M	O	R	S		AA*
2	GA	1028609	2.5	3.00	1.50	1.75	3.59	1.50	1.00	1.16	1.06	.88	7.64	.88	1.00	6.01	.63	2.00	1096421
3	HA	1028618	3.8	3.50	1.56	2.00	4.00	1.62	1.13	1.31	1.19	.94	8.60	.94	1.09	6.72	.75	2.00	1096468
5	IA	1028627	7.0	4.00	1.56	2.25	4.84	2.00	1.44	1.63	1.50	1.31	10.32	1.13	1.36	8.00	.88	2.50	1096515
7	JA	1028636	14.0	5.00	1.94	2.75	6.27	2.50	1.81	2.06	1.78	1.66	12.84	1.44	1.61	9.90	1.13	3.00	1096562
11	KA	1028645	22.3	5.62	2.05	3.12	7.54	3.00	2.25	2.63	2.41	1.88	15.24	1.63	2.08	11.74	1.25	4.00	1096609
15	LA	1028654	36.0	7.12	3.62	4.10	8.33	3.25	2.59	2.94	2.62	2.19	18.64	1.94	2.27	14.41	1.50	4.00	1096657

4.5:1 Design Factor. Maximum allowable proof load is 2.5 times Working Load Limit. *Deformation indicators.



Ep. 21 Grinding and wear allowance on rigging hardware



Ep. 31 Crosby Shurlock® Hook inspection requirements



Ep. 5 Hooks: Why the tips must point outward on multiple bridles

VIDEO PODCAST SERIES

Our experts answer some of your most common safe rigging, lifting, and securement questions in our video podcast series, *Ask the Expert*.

Watch all episodes and submit your questions at thecrosbygroup.com/podcast, and subscribe to our YouTube channel to catch every new video as soon as it's released.

Ask the Expert

VIDEO PODCAST